



*Inspiration strikes*

## **CYCLONE|X**

Bolt PP-600 Power Pack  
for Portable Flashes

User's Manual



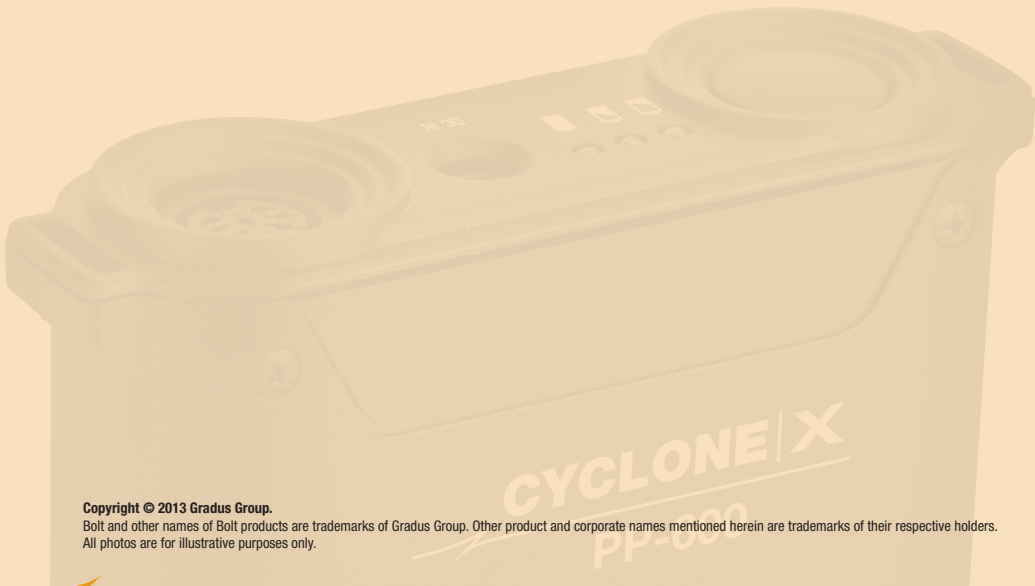

**Copyright © 2013 Gradus Group.**

Bolt and other names of Bolt products are trademarks of Gradus Group. Other product and corporate names mentioned herein are trademarks of their respective holders. All photos are for illustrative purposes only.



## Introduction

Thank you for choosing the Bolt Cyclone X Power Pack for Portable Flashes. This lightweight and portable rechargeable large-capacity lithium-ion power pack will supply up to 900 flashes with many popular portable flash units. When using a 400w/s monolight capable of being powered by an HV cord, this unit can provide up to 400 full-power flashes. It's compatible with most flashes that have an HV port, including Nikon, Canon, Sony, Quantum, Olympus, Bolt, Sunpak, Vivitar, and Metz.

### Box Contents:

- Cyclone X Power Pack
- BO-1009 AC battery charger
- Shoulder strap
- Belt clip
- US, UK and European power plug adapters
- User instruction manual

## Overview

- 1** Shoulder strap lugs
- 2** Power button
- 3** LED battery level indicators
- 4** Charging port
- 5** HV cable socket
- 6** Belt clip
- 7** Shoulder strap
- 8** BO-1009 AC charger
- 9** USA power plug adapter
- 10** UK power plug adapter
- 11** European power plug adapter

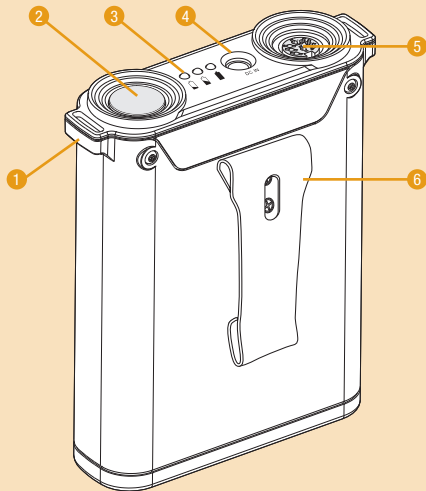



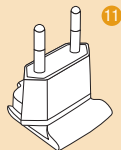
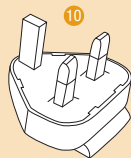
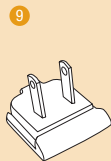
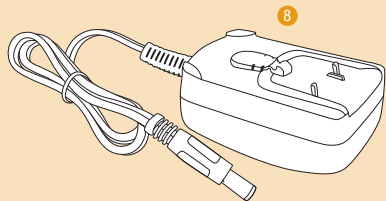
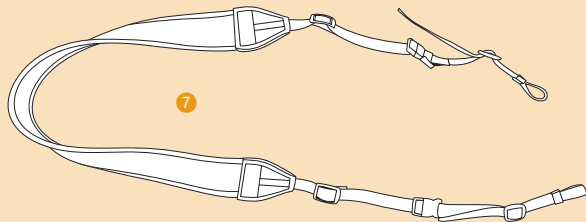

## Warnings



- Do not disassemble or attempt to maintain this product yourself. Doing so will void the warranty, and Bolt will not be responsible for any damage. There are high-voltage components inside. Contact can produce a dangerous electric shock.
- Keep out of reach of children.
- This product is not water resistant. Keep it away from water and all flammable gases or liquids.
- Do not store or use this product at temperatures above 104°F (40°C)
- Do not connect this product to a charger other than the included unit.
- To avoid overheating and damaging your flash unit, please wait for at least 10 minutes after 40 continuous full-power flashes.
- Make sure the unit is powered off when plugging it in to a power source.
- Use only the correct, recommended voltage.
- Handle the unit with care.
- Clean the unit with a soft, dry cloth.
- Use only parts provided by the manufacturer.

- Please read and follow these instructions and keep this manual in a safe place.
- Make sure the item is intact and that there are no missing parts.
- All photos are for illustrative purposes only.

## Charging the Cyclone X

### **To charge your Cyclone X with the included charger:**

1. Choose the correct power plug adapter.
2. Slide the power plug adapter into the provided slot on the charger.
3. Be sure the adapter clicks securely into place.
4. Plug the charger into an AC outlet.
5. Plug the charger cable into the charging port on the Cyclone X.
6. If one or more of the indicator lights are blinking, the battery is being charged.
7. If the three indicator lights all light up and are not blinking, the battery is charged.
8. Charging time is approximately four hours.

**To get the maximum capacity from your Cyclone X:**

Charge your Cyclone X shortly before use to ensure that the pack retains the maximum charge. Charge your Cyclone X at a moderate room temperature, and avoid storing it in hot environments between charging and use.

**Note:** When charging the pack outside of the United States, use the correct plug adapter (US, UK, and European adapters are included) to plug the charger into any 100-240 V AC power outlet.

**Checking the Cyclone X's charge level:**

You can check the charge level on the Cyclone X by pressing the power button.

The battery indicator LEDs will illuminate to indicate the charge level as follows:

Three battery LEDs on: 100% charge level

Two battery LEDs on: 70% charge level

One battery LED on: 30% charge level

One battery LED blinking: 10% charge level

When one battery LED is blinking, the Cyclone X has a 10% charge level.

## Connecting Your Bolt Cyclone X Power Pack to Your Flash

You can use the Cyclone X to power a wide range of flash units. To connect the Cyclone X to a flash unit, you must use a compatible connection cable. Some cables sold by flash and power pack manufacturers are interchangeable with Bolt cables, but other flash brands use a different connector type. Make sure you select the right one for the flash being used.

Most compatible flash units require the standard batteries to be installed in the flash in order to power the computer functions that allow the flash to work.

**Important! Most compatible flash units require the standard batteries to be loaded before connecting the unit to the Cyclone X. You may need to set your flash unit to recycle by drawing power only from the Cyclone X to avoid draining the installed batteries. Check your flash unit's manual for details on the relevant setting.**

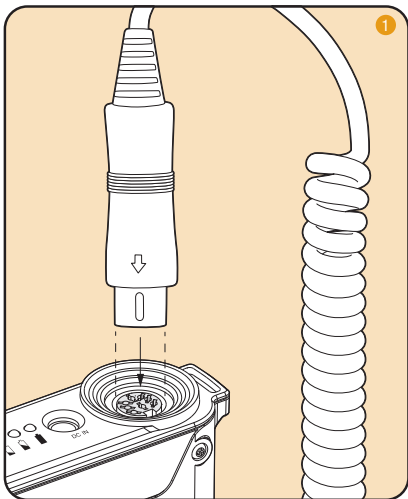

**To connect your Cyclone X to your flash unit:**

1. Plug the metal connector of the connection cable firmly into the output socket of the Cyclone X.
2. Plug the other end of the connection cable securely into the compatible power port on your flash unit and turn on the flash.
3. Press the power button on the Cyclone X and wait for the battery LEDs to light up.
4. The LED battery level indicators will glow red to indicate the charge level of the battery when the Cyclone X is connected to your flash unit.

**To disconnect your Cyclone X from your flash unit:**

1. Press and hold the power button until the battery LEDs turn off.
2. Unplug the connection cable from the Power Pack.
3. Unplug the connection cable from the flash unit.

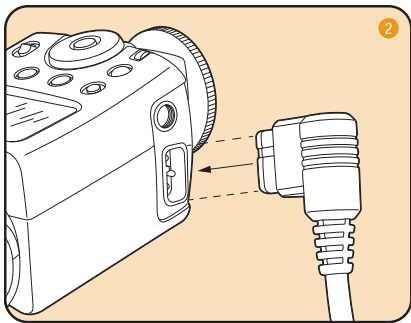

## Using Your Flash with Your Cyclone X

Your Cyclone X can recycle in just 1 second with many popular flash units—you won't miss a shot waiting for your flash to be ready. With the flash firing at full power, the Cyclone X can provide up to 900 flashes, depending on the specific unit you're using. With most flash units, when the unit is set to TTL mode, the Cyclone X can power thousands of shots.

### To get the best use out of your Cyclone X:

- Use in environments with moderate temperatures.
- Don't fire more than 40 full-power flashes without pausing. Doing this can overheat and even damage your flash. The Cyclone X has a much higher power output than the typical batteries used to power a flash unit. Refer to the flash unit's instruction manual for information on its continuous full-power flash capacity and limitations.

## Carrying and wearing the Cyclone X:

The Cyclone X is designed to be easy to carry and inconspicuous. Its light weight and compact design make it easy to wear for long periods of time, and its black finish and clean design make it unobtrusive. It also offers a shoulder strap—thread the shoulder strap through the built-in lugs on the Cyclone X and through the strap clips and buckles, as shown below. After threading it, pull it tight to take up any slack. Always make sure that your strap is attached securely—dropping the Cyclone X can damage it. The Cyclone X is also provided with a belt clip which can be used for carrying the power pack attached to your belt.

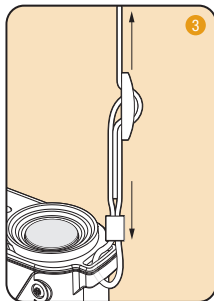
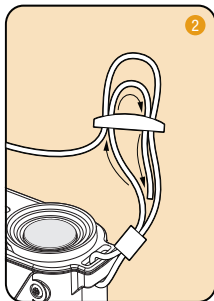
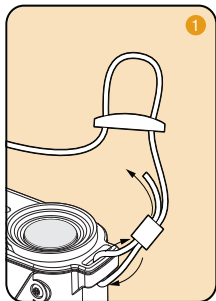



# Troubleshooting

Problem	Solution
The Cyclone X is charged and connected to a flash with a cable, but no charge level LEDs light up when you turn the unit on.	The cable is damaged, or you are using the wrong cable.
The Cyclone X is charged and connected to a flash with a cable, but the flash does not fire.	Ensure that you have the correct internal batteries installed in the flash. These may be required for its internal computer functions to work.

## Customer Service

For customer service, please go to [www.boltflashes.com](http://www.boltflashes.com).

## Compatible Devices and Accessories

The Cyclone X is compatible with a wide range of hotshoe and handle-mount flash units. Make sure you select a connection cable that is compatible with your flash unit.

Many compatible accessories are also available from Bolt and other brands. Bolt connection cables are interchangeable with some other manufacturers' battery pack connection cables.

**These optional accessories are available from Bolt:**

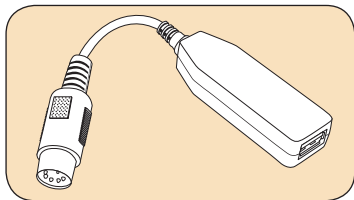

Bolt USB-C Charger for Mobile Devices

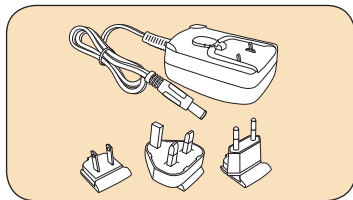

Bolt BO-1009 Replacement Charger  
with US, UK and European adapters

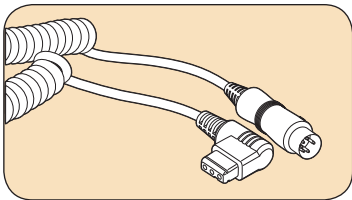

BO-1001 CZ Canon flash cable

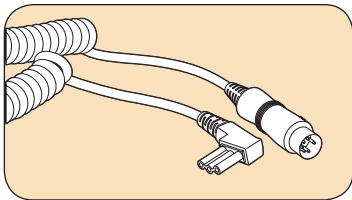

BO-1002 CKE Nikon flash cable

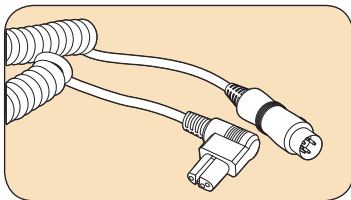

BO-1005 Sony Flash Cable

# Specifications

## Power Pack Cyclone X:

*Battery type:* lithium-ion

*Output Voltage:* 325V+3V DC

*Input Voltage:* 9.6V AC

*Capacity:* 3000 mAh

*Watt hour:* 250

*Recycle time with hotshoe-mounted flash units:* approximately 1 second (at full power)

*Flashes per charge:* approximately 900 flashes with most popular portable flash units and thousands of flashes when the flash is set to the TTL mode. With 400w/s monolights that use an HV cord the unit can provide up to 400 full-power flashes.

*Battery charging time:* approximately 4 hours

*Operation environment working temperature range:* -4°F to 104°F (-20°C to 40°C)

*Operation environment working humidity:* 85% or less

*Dimensions:* 5.25 × 3.75 × 1.37 in. (133.35 × 95.25 × 34.80 mm) including belt clip

*Weight:* 17.28 oz. (490 g)

## AC Charger BO-1009:

*Input:* 100-240V AC 50/60Hz

*Output:* 11.5V+0.2V 800mA

*Weight:* 3 oz. (85 g)

*Cord length:* 22 in. (1.5 m)

*Dimensions:* 1.8 x 2.8 x 1.3 in.  
(46 x 71 x 33 mm)

Notes:

---

---

---

---

---

---

---

---

---

---

---

---



Notes:

---

---

---

---

---

---

---

---

---

---

---

---

# Warranty

## LIMITED ONE-YEAR WARRANTY

Bolt provides a limited warranty that this product is free from defects in materials and workmanship to the original purchaser under normal use for a period of one (1) year from the original purchase date or thirty (30) days after replacement (the “Warranty Period”), whichever occurs later. Our responsibility with respect to this limited warranty shall be limited solely to repair or replacement, at its option, of any product which fails during normal consumer use.

To obtain warranty coverage during the Warranty Period, contact your place of purchase (“Seller”) to obtain a return merchandise authorization (“RMA”) number, and return to Seller the defective product along with proof of purchase and the RMA number.

This warranty does not extend to damage or failure which results from misuse, neglect, accident, alteration, abuse, improper installation or maintenance. EXCEPT AS PROVIDED HEREIN, BOLT MAKES NEITHER ANY EXPRESS WARRANTIES NOR ANY IMPLIED WARRANTIES, INCLUDING BUT NOT LIMITED TO ANY IMPLIED WARRANTY OF MERCHANTABILITY OR FITNESS FOR A PARTICULAR PURPOSE. This warranty provides you with specific legal rights, and you may also have additional rights which vary from state to state.

[www.boltflashes.com](http://www.boltflashes.com)



[www.boltflashes.com](http://www.boltflashes.com)

Copyright © 2013 Gradus Group