

PRECAUTIONS

- Make sure this product is intact and that there are no missing parts.
- Do not dismantle the gas lift for any reason.
- Clean the chair with only a soft, dry cloth.
- Make sure everything is secure before use.
- Use the chair on a flat surface only.
- Do not stand on the chair.
- Do not sit close to the front of the chair—sit all the way back.
- Do not put your weight only on the backrest while the chair is in a fully reclined position.
- Do not let anyone press down on the backrest while the chair is in a fully reclined position.
- Do not seat more than one person at a time in this chair.
- All images are for illustrative purposes only.

PARTS AND SUPPLIES

- | | | | |
|--------------------|-------------------------|------------------------------|------------------------------|
| A. Seat back | E. Tilt mechanism | I. Piston cover | M. M6 screw × 2 ¹ |
| B. Seat base | F. Five-star wheel base | J. Upper side covers × 2 | |
| C. Headrest pillow | G. Casters × 5 | K. Hex key × 2 (M8)(M6) | |
| D. Lumbar pillow | H. Gas lift piston | L. M8 screw × 8 ¹ | |

¹ Some screws may arrive preinstalled.

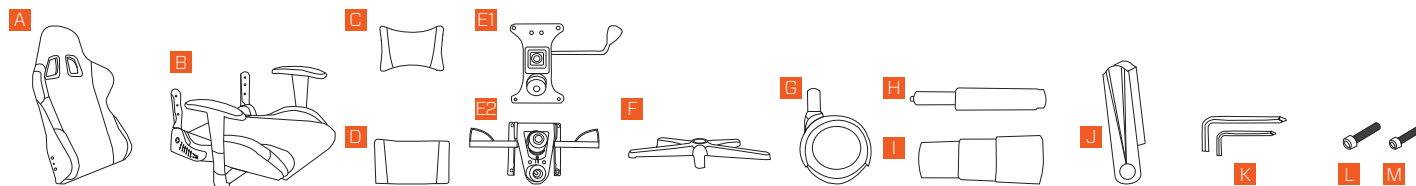

ADJUSTING THE CHAIR

Seat-Back Tilt Adjustment

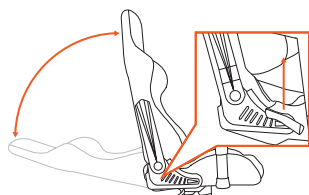

Chair Tilt Tension

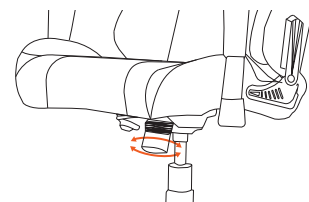

Chair Tilt

Single-Arm Mechanism

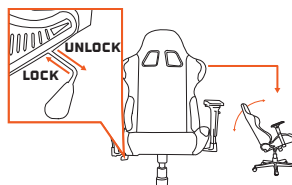

Dual-Arm Mechanism

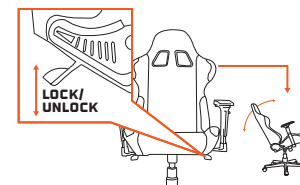

Armrest Adjustments

3D Armrest

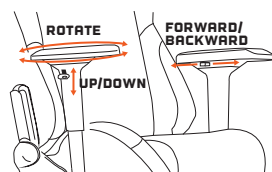

4D Armrest

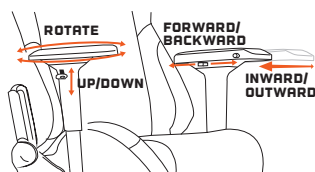

Chair Height Adjustment

Single-Arm Mechanism

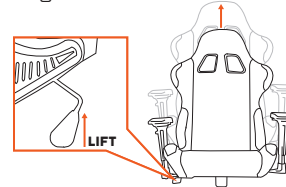

Dual-Arm Mechanism

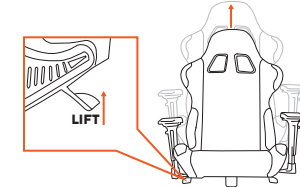

ASSEMBLY INSTRUCTIONS

To avoid scratching, lay down a towel or other soft material where you're going to assemble the chair. The chair shown in the photos might be a different model, but assembly is the same for all models. It may be necessary to remove the preinstalled screws before assembling some parts of the chair. We recommend assembling the chair with two people.

1. Place the seat base flat on a soft surface.
2. Align the seat back with the seat-back brackets attached to the seat base. Make sure the brackets are pointing up at 90°. It may be necessary to remove any fabric to ensure the screws can be inserted properly [Fig. 1].
3. Use the M8 hex key and screws to secure the seat back to the seat-back brackets on each side [Fig. 2].
4. Attach the upper side covers into the lower side cover's snap fastener [Fig. 3].
5. Secure the upper side covers using the M6 screws and hex key [Fig. 4]. Make sure not to overtighten the screws.
6. Flip the chair over.
7. Align the tilt mechanism with the four M8 holes on the bottom side of the seat base. Make sure the tilt tension knob is toward the front of the chair.
8. Use the M8 screws and hex key to fasten the tilt mechanism to the underside of the seat base (Single-Arm Mechanism [Fig. 5], Dual-Arm Mechanism [Fig. 6]).
9. Place the piston cover over the gas lift piston [Fig. 7].
10. Insert the smaller end of the gas lift piston into the center port of the tilt mechanism, and press down firmly [Fig. 8].
11. Align the hole in the wheel base with the base of the gas lift piston, and press firmly until secure [Fig. 9].
12. Insert the casters into the holes on the wheel base [Fig. 10].
13. Flip the chair upright onto the wheels and make sure everything is secure before use.

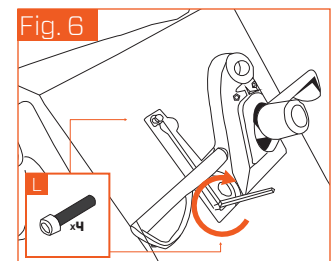
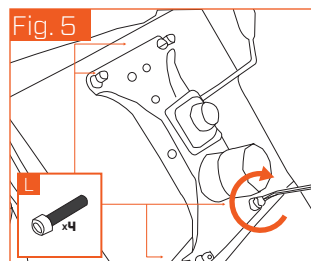
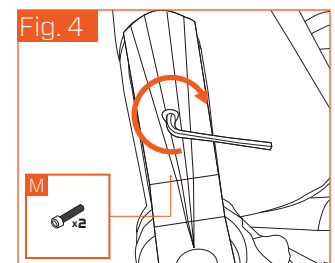
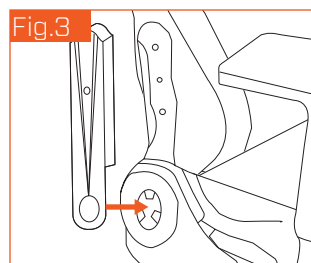
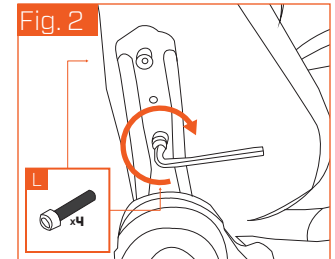
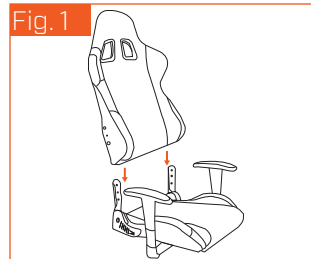

Single-Arm Mechanism

Dual-Arm Mechanism

