

8.0M LONG DISPERSION TRENCH
"EVERGLAS SQUARELINE"
REFER TO TYPICAL SECTIONS

PROPOSED 2,000 LITRE RAINWATER TANK
AS REQUIRED BY DWSIX - WITH OVERFLOW
TO DISPERSION TRENCH

PROPOSED GRANNY FLAT

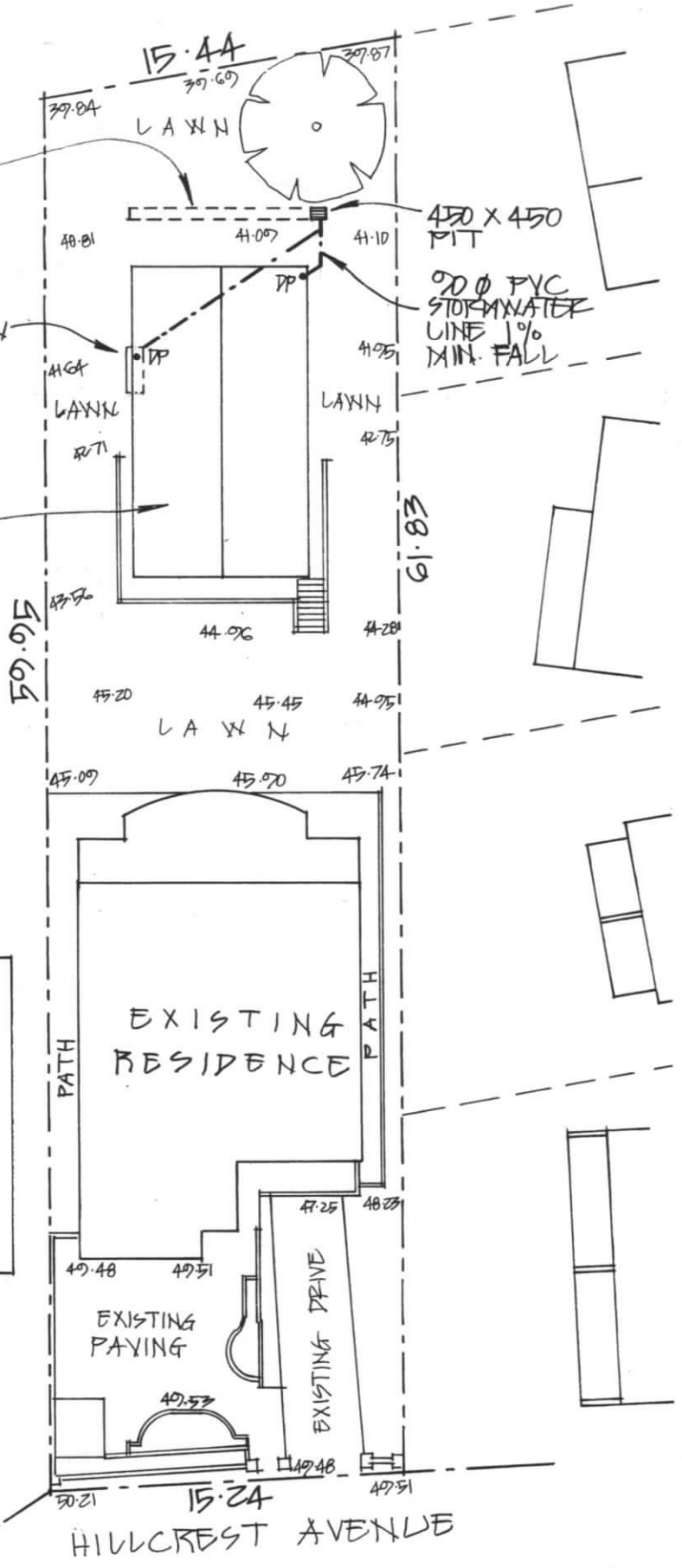

STORMWATER CONCEPT PLAN

SCALE 1:200

AMENDMENTS	PROPOSED GRANNY FLAT
	LOCATION: 3 HILLCREST AVENUE, MONA VALE
	FOR: MR.R & MRS.D. BOOT
	JUNE 2014 - DRAWN BY: NICK.K - JOB NO. 141541
	STORMWATER CONCEPT PLAN - SHEET 1 OF 2 - A3 SHEET

