

Smart Wireless Keyboard (VG-KBD2000)

Accessories

- User manual
- Batteries (AA x 2)
- Warranty card

Update TV

▲ To use Smart Wireless Keyboard, the TV should be updated by USB or Online.

Using USB

- Download the latest TV software at www.samsung.com and extract it to the USB using your PC.
- Turn on the TV, and then insert the USB into the USB port of the TV.
- In the TV's menu, go to **Support** → **Software Update** and select **"By USB"**.
- The TV upgrades the software, turns off, and then turns on automatically.

On screen menu

- Connect your TV to internet network.
- In the TV's menu, go to **Support** → **Software Update** and select **"Online"**.
- If there is a download available, the Download pop-up appears with a progress bar and the download starts.
- When the download is complete and the Upgrade Query screen appears, select **Update Now**.
- The TV upgrades the software, turns off, and then turns on automatically.

For more detail information, refer to the e-Manual.

User manual

Use the wireless keyboard as a remote control as described below.

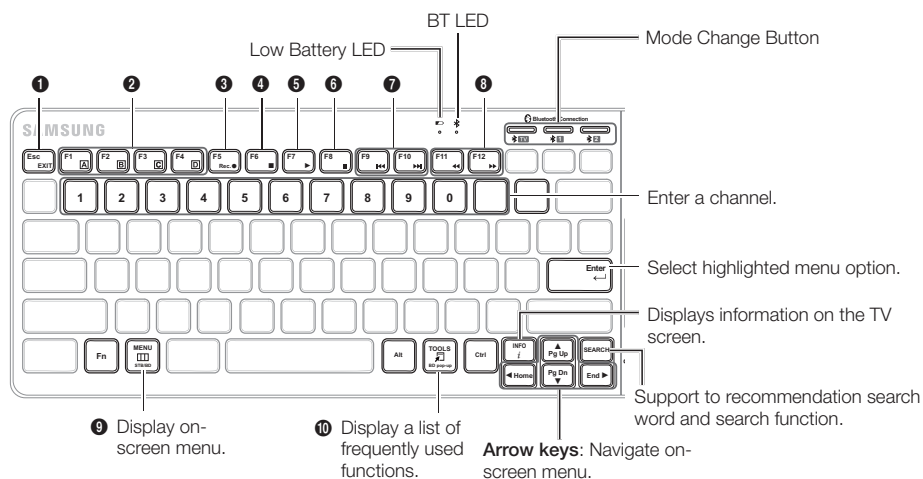

These keys below are available only with high-class models. Upgrade the TV to the latest firmware and set up the IR Extender Cable to use the keys.



	Compatible Models
Korea	LED F6330 and higher / PDP F5500 and higher / Samsung mobiles (Android-based)
The other countries	LED F6400 and higher / PDP F5500 and higher / Samsung mobiles (Android-based)

You can use the following functions by pressing the keys below with the Fn key.

To use the keys below, you should update your TV by USB or Online and set your IR Blaster.

1		Exit Menu	7		Play the previous, next file		
3		Recording	8		Rewind, Fast forward		
4		Stop	9		Display the STB or BD menu.		
5		Play	10		Display the BD pop-up.		
6		Pause					
1		Return	Go to previous menu screen.	5		CH LIST	Display list of available channels.
2		Color keys	Use these keys, being guided by on-screen help.	6		Mute	Turn sound off or on.
3		Smart Hub	Display list of available applications.	7		Volume	Increase or decrease volume.
4		Source	Change input device.	8		Channel	Change channel up or down.

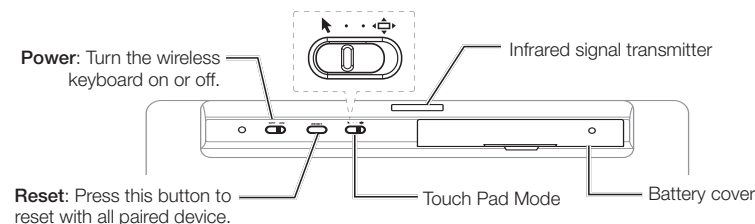
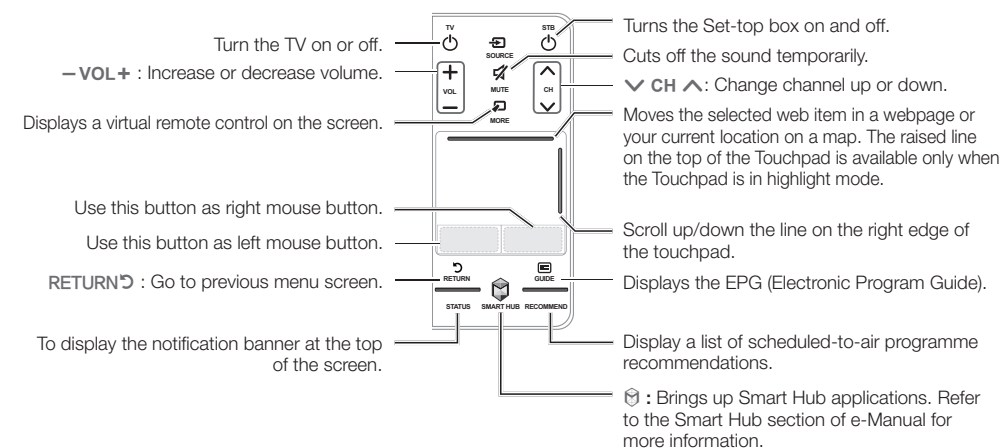

Switching the Touchpad

- Pointer mode**: Rub a finger or thumb on the Touchpad to move the mouse pointer on the screen. Click the Touchpad to select a menu item.
- Highlight mode**: Rub on the Touchpad to move the highlight bar on the screen. Click the Touchpad to select a menu item.

Inserting batteries

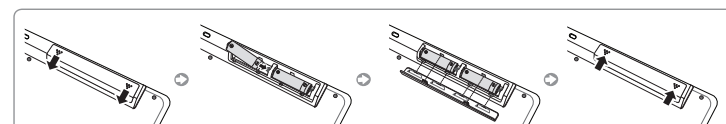

Pairing

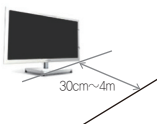

This keyboard can be paired with up to three devices simultaneously, including a Samsung TV, and the keyboard can switch between them.

When turning on the keyboard, the **TV** and **1** indicator lights blink simultaneously for 5 minutes if the keyboard is paired with no device.

If it is paired with any device, the two indicator lights blink simultaneously once.

Initial Pairing with a Samsung TV **TV**

1. Turn on the TV.
2. Turn on the wireless keyboard, and then move it to the direction of your TV.
3. Press anykey except MENU, Ctrl, Alt or **TV** button for 3 seconds.
4. **TV** or **1** indicators blink twice at the same time and stop blinking when pairing succeeds.

Re-pairing with the TV after a Disconnection **TV**

1. Turn on the TV.
2. Turn on the wireless keyboard, and then move it to the direction of your TV.
3. Press **TV** button for 3 seconds.
4. **TV** or **1** indicators blink twice at the same time and stop blinking when pairing succeeds.

Pairing with Other Devices **1**, **2**

1. Press and hold the **1** or **2** button under **Bluetooth Connection** for 3 seconds.
2. Scan available Bluetooth devices on the target device.
3. Choose "Samsung Wireless Keyboard" from the list of detected Bluetooth devices.
 - If the pairing is failed, "TV", "Device1", "Device2" button is pressed within 3 seconds and then try mode change.
4. The **1** and **2** indicator lights blink simultaneously twice when pairing is complete.

Switching between Devices

Press a **Bluetooth Connection** **TV**, **1**, **2** button to switch to the associated device. The **1** indicator light blinks twice. The **1** indicator light uses three different colors to indicate what device is currently paired with the keyboard.

- **TV** : Green for the TV
- **1** : Red for the first other device
- **2** : Amber for the second other device

Reset

To delink the keyboard from its associated devices, press the **Reset** button on the top of the keyboard's back for 3 seconds. The **1** and **2** indicator lights blink simultaneously for 10 seconds.

Specification

Model	Smart Wireless Keyboard (VG-KBD2000)
Battery	AA x 2
Dimension (mm) (Length) x (Depth) x (Height)	317.0 x 9.6 x 123.8 mm
Weight	405g without batteries (AA battery: 45g)

Compatible Models

2012	Korea	LED ES6350 and higher / PDP E550 and higher / Samsung mobiles (Android-based)
	North America, Latin America	LED ES6500 and higher / PDP E550 and higher / Samsung mobiles (Android-based)
	The other countries	LED ES6100 and higher / PDP E550 and higher / Samsung mobiles (Android-based)
2013	Korea	LED F6330 and higher / PDP F5500 and higher / Samsung mobiles (Android-based)
	The other countries	LED F6400 and higher / PDP F5500 and higher / Samsung mobiles (Android-based)

It may not be compatible according to the specifications of the device.

WARRANTY

This Samsung product is warranted for the period of twelve (12) months from the original date of purchase, against defective materials and workmanship. In the event that warranty service is required, you should first return the product to the retailer from whom it was purchased. However, Samsung Authorized Service Centres will comply with this warranty during the Warranty Period. To obtain details, please contact your nearest Authorized Service Centre.

PROCEDURE FOR MAKING A WARRANTY CLAIM

To make a claim under the warranty, you must contact the Samsung Contact Centre during the Warranty Period to discuss the problems you are having with the product. If a repair or replacement is required, you will be provided with a Warranty Claim Number and address of an Authorised Service Centre. If you are provided with a Warranty Claim Number, to obtain a repair or replacement of the product, you must send the product to the Authorised Service Centre advised together with:

- i) a copy of your completed warranty card or, if you have already provided this to Samsung, your name, address and contact telephone number;
- ii) your original receipt, invoice or sales slip for the purchase of the product as new;
- iii) your Warranty Claim Number.

Samsung will then repair or replace the product and return it to you using the contact details provided.

WARRANTY CONDITIONS

1. The warranty is only valid if the above procedure for making a warranty claim is followed.
2. Samsung's obligations are limited to the repair or, at its discretion, replacement of the product or the defective part.
3. Warranty repairs must be carried out by Samsung Authorised Service Centres. No re-imbursement will be made for repairs carried out by service centres or dealers that are not authorised by Samsung and any such repair work and damage to the products caused by such repair work will not be covered by this warranty.
4. This product is not considered to be defective in materials nor workmanship by reason that it requires adaptation in order to conform to national or local technical or safety standards in force in any country other than the one for which the product was originally designed and manufactured. This warranty will not cover, and no re-imbursement will be made for such adaptation, nor any damage which may result.
5. The warranty does not apply to any product that has been damaged or rendered defective as a result of any of the following excluded reasons, namely:
 - a. as a result of accident, misuse, or abuse;
 - b. through the failure to use this product for its normal purposes;
 - c. by the use of parts not manufactured or sold by Samsung;
 - d. by modification without the written permission of Samsung;
 - e. by damage resulting from transit, neglect, power surge or failure;
 - f. by damage resulting from lightning, water, fire, or acts of God;
 - g. as a result of normal wear and tear; or
 - h. difference in broadcasting methods or product standards between countries.
6. This warranty is valid for any person who legally acquired possession of the product during the warranty period.
7. NOTHING IN THESE WARRANTY CONDITIONS SHALL EXCLUDE OR LIMIT SAMSUNG'S LIABILITY FOR DEATH OR PERSONAL INJURY CAUSED BY THE PROVEN NEGLIGENCE OF SAMSUNG, UNLESS SUCH LIMITATION OR EXCLUSION IS PERMITTED BY APPLICABLE LAW.
8. WITH THE EXCEPTION OF SAMSUNG'S LIABILITY WHICH CANNOT BE EXCLUDED OR LIMITED BY LAW, SAMSUNG SHALL NOT BE LIABLE FOR: ANY INDIRECT, INCIDENTAL, SPECIAL OR CONSEQUENTIAL DAMAGES LOSSES OR EXPENSES; OR LOST PROFITS; OR LOSS OF USE OR LOSS OF DATA; OR DAMAGE TO GOODWILL, REPUTATION OR LOST BUSINESS, ARISING DIRECTLY OR INDIRECTLY, FROM THE PURCHASE, USE OR SALE OF THE PRODUCT, WHETHER OR NOT SAMSUNG WAS ADVISED OR AWARE OF THE POSSIBILITY OF SUCH DAMAGES, LOSSES OR EXPENSES.
9. WITH THE EXCEPTION OF SAMSUNG'S LIABILITY WHICH CANNOT BE EXCLUDED OR LIMITED BY LAW, SAMSUNG'S LIABILITY UNDER OR IN CONNECTION WITH THIS WARRANTY OR THE PURCHASE, USE OR SALE OF THE PRODUCT SHALL NOT EXCEED THE PRICE PAID FOR THE PRODUCT AS NEW.
10. UNLESS PROVIDED FOR IN THIS WARRANTY, ALL CONDITIONS, WARRANTIES AND TERMS IMPLIED BY STATUTE OR OTHERWISE ARE HEREBY EXCLUDED TO THE MAXIMUM EXTENT PERMISSIBLE BY LAW.
11. The above warranty conditions do not affect your statutory rights as a consumer or otherwise.

Notice

◆ FCC Statement

This equipment has been tested and found to comply with the limits for a Class B digital device, pursuant to Part 15 of the FCC Rules. These limits are designed to provide reasonable protection against harmful interference in a residential installation. This equipment generates, uses and can radiate radio frequency energy and, if not installed and used in accordance with the instructions, may cause harmful interference to radio communications. However, there is no guarantee that interference will not occur in a particular installation. If this equipment does cause harmful interference to radio or television reception, which can be determined by turning the equipment off and on, the user is encouraged to try to correct the interference by one of the following measures:

- Reorient or relocate the receiving antenna.
- Increase the separation between the equipment and receiver.
- Connect the equipment into an outlet on a circuit different from that to which the receiver is connected.
- Consult the dealer or an experienced radio/TV technician for help.

FCC Caution:

Any changes or modifications not expressly approved by the party responsible for compliance could void the user's authority to operate this equipment.

This device complies with Part 15 of the FCC Rules. Operation is subject to the following two conditions:

- (1) This device may not cause harmful interference, and
- (2) this device must accept any interference received, including interference that may cause undesired operation.

IMPORTANT NOTE:

FCC Radiation Exposure Statement:

This equipment complies with FCC radiation exposure limits set forth for an uncontrolled environment.

◆ IC Statement

This Class B digital apparatus complies with Canadian ICES-003.

Cet appareil numérique de la classe B est conforme à la norme NMB-003 du Canada.

This device complies with Industry Canada licence-exempt RSS standard(s). Operation is subject to the following two conditions: (1) this device may not cause interference, and (2) this device must accept any interference, including interference that may cause undesired operation of the device.

Le présent appareil est conforme aux CNR d'Industrie Canada applicables aux appareils radio exempts de licence. L'exploitation est autorisée aux deux conditions suivantes : (1) l'appareil ne doit pas produire de brouillage, et (2) l'utilisateur de l'appareil doit accepter tout brouillage radioélectrique subi, même si le brouillage est susceptible d'en compromettre le fonctionnement.

IC Radiation Exposure Statement:

This equipment complies with IC RSS-102 radiation exposure limits set forth for an uncontrolled environment.